

## RP3

AUTOMATIC DOOR BOTTOM SEALS



It is quick and easy to install without cutting or removing the door and uses concealed fasteners. This DIY product has been granted an Australian Design Award. Ideal for residential and light commercial applications such as motels and retirement villages.

Can be used in conjunction with Raven threshold plates.

### SPECIFICATIONS

**Location**

Bottom of single inward opening butt hinged doors.

**Size/Length (Length can be cut back to)**

820mm (385mm), 920mm (385mm), 1220mm (920mm)

**Fixing**

Face Mounted, Screw Fixed

**Fixing Note**

Zinc plated, cross recess head S.T. screws supplied. Fixing holes are pre-slotted.

**Min & Max Gap**

3mm to 16mm

**Replacement Seals**

[RP303](#)

**Available Colours**

Black Anodised, Bronze Anodised, Gold Anodised, Silver Anodised

**Product Sizes/Lengths:** Product lengths greater than 2m can only be purchased from Raven distributors and stockists. Please contact Raven Sales for assistance

**Material**

Aluminium

**Door/Frame Construction**

Timber

**Door Type**

Single Inward Opening

**Material Description**

Anodised aluminium with black EPDM gasket.

Note: Architectural perimeter seal and door bottom extrusions are anodised 15µm and threshold plates are anodised 25µm for maximum durability. Black aluminium is anodised 25µm to 40µm.

**User determined gap**

No

**Prior to installation gap**

No

## APPROVALS

**Fire AUS/NZ**

AS 1530.4:2005 &amp; earlier, NCC Spec C3.4

**Fire Rating**

Up to FRL &amp; FRR-/60/30

**Fire Flammability Index**

Gasket flammability index < 5 when tested to AS1530.2

**Energy AUS/NZ**

ABC Housing Provisions Standard 2022 13.4.4, NCC J5D5

**Durability**

Tested to over 1,000,000 operating cycles without failure

**Insects & Vermin AUS/NZ**

AS 4674 Sect. 2.1.5 Pt. (iv), AS 4674 Sect. 2.1.7

## VARIATIONS

**Product Code**
**Colour**
**Length**

**Product Sizes/Lengths:** Product lengths greater than 2m can only be purchased from Raven distributors and stockists. Please contact Raven Sales for assistance

R3C	Silver Anodised	920mm (cut back to 385mm)
R3BK	Black Anodised	920mm (cut back to 385mm)
R3B4	Bronze Anodised	1220mm (cut back to 920mm)
R3B	Bronze Anodised	920mm (cut back to 385mm)
R3C820	Silver Anodised	820mm (cut back to 385mm)
R3G	Gold Anodised	920mm (cut back to 385mm)
R3G4	Gold Anodised	1220mm (cut back to 920mm)
R3C4	Silver Anodised	1220mm (cut back to 920mm)

**Product Sizes/Lengths:** Product lengths greater than 2m can only be purchased from Raven distributors and stockists. Please contact Raven Sales for assistance

### HOW TO FIT RP3

- Seal must be fitted to the front face of inward opening doors.
- **Note:** If one side of RP3 is hard to seal, then lower RP3 on the fixing screws.

**FIG.A** (section view)

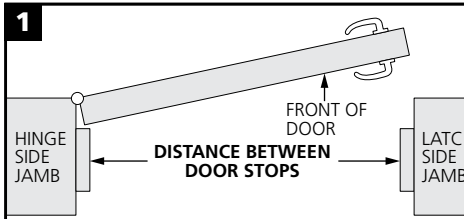
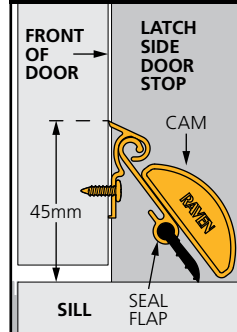

- With door closed, measure front of door between door stops. Cut seal with a hacksaw to measurement less 3mm for clearance on latch side. **Note:** If door is less than 650mm wide, trim equal amounts from each end to avoid mechanism damage. 385mm is the minimum operable size.

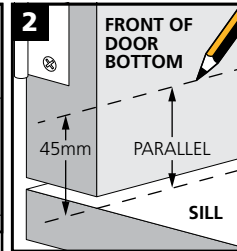

- With door closed, mark line on front of door bottom, parallel to and 45mm up from door sill.

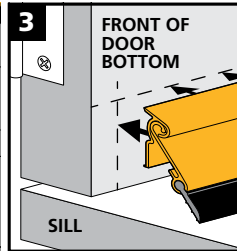

- Position top edge of seal on marked line and firm against hinge side stop.

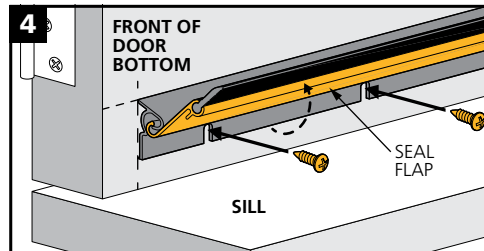

- Lift seal flap and mark positions for screws in the middle of the fixing slots.
- Remove RP3 and in the marked screw positions, fix the four short screws in half way. Reposition RP3 on screws and fully tighten.

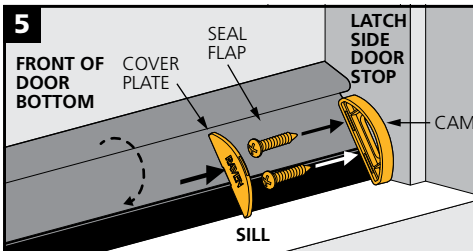

- With door closed, position cam to the latch side door stop so it lightly closes seal flap (FIG.A).
- With long screw, fix cam in top of slot. Adjust as necessary then fix in bottom slot with 2nd screw.
- Check sealing action then snap in cover plate.