

RP17b

DOOR BOTTOM SWEEP SEALS



Co-extrusion (Adhesive backed).

A co-extruded PVC sweep seal that fits to the stiles or bottom of doors. These extremely Flexible seals can be quick and easily installed without removing the door. Ideal for sliding and security screen doors.

Can be used in conjunction with Raven RP13 and RP82 threshold plates.

SPECIFICATIONS

Location

Bottom of or around sliding or outward opening butt hinged doors.

Size/Length

920mm, 1000mm, 3000mm

Fixing

Screw Fixed, Self-adhesive

Fixing Note

Self-adhesive or can be screw fixed. Note: Contact surface must be clean, smooth and if painted, well cured. Self-adhesive seals will not adhere to oiled or alkyd finishes or to easy clean wash and wear paint surfaces.

Min & Max Gap

0mm to 19mm

Available Colours

Brown, White

Material

Rigid and Flexible PVC

Product Sizes/Lengths: Product lengths greater than 2m can only be purchased from Raven distributors and stockists. Please contact Raven Sales for assistance

Door/Frame Construction

Timber, Aluminium

Door Type

Single Inward Opening, Single
Outward Opening, Double Inward
Opening, Double Outward
Opening, Sliding, Pivot, Security
Screen, Bi-fold

User determined gap

Yes

Prior to installation gap

No

APPROVALS

Energy AUS/NZ

ABCB Housing Provisions Standard 2022 13.4.4, NCC
J5D5

Insects & Vermin AUS/NZ

AS 4674 Sect. 2.1.5 Pt. (iv), AS 4674 Sect. 2.1.7

VARIATIONS

Product Code	Colour	Length
A17BBR1000	Brown	1000mm
A17BBR3000	Brown	3000mm
A17BW1000	White	1000mm
A17BW3000	White	3000mm
R17B	Brown	920mm
R17W	White	920mm

Product Sizes/Lengths: Product lengths greater than 2m can only be purchased from Raven distributors and stockists. Please contact Raven Sales for assistance

FITTING INSTRUCTIONS

RP17 - Door Bottom Sweep Seal



HOW TO FIT RP17

Note: For easy door operation, determine which side of the door the RP17 will function best. Flexible seal should lightly engage the sealing surface and sweep smoothly across the floor. Uneven or ramped floors may cause the seal to drag. Recommended adhesion temperature is above 21°C. Allow a few days for full adhesion strength to occur.

- Seal can be fitted to the inside or outside of the door. Surface must be clean, smooth and if painted, well cured. *Note: Self-adhesive seals will not stick to oil-rub finishes.*

FIG.A (section view)

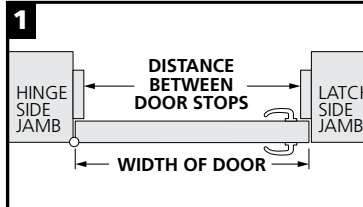
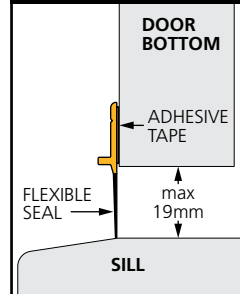

- Measure the side of the door you wish to fit the seal, either between the stops or the full width of the door.

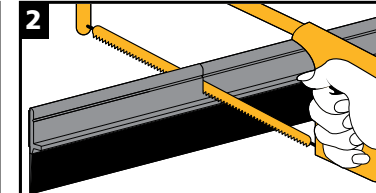

- With a fine toothed hacksaw, cut seal to the required length.

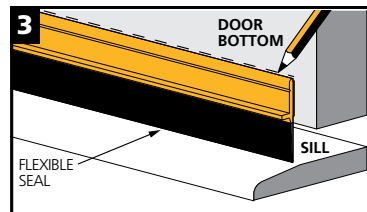

- Before removing adhesive backing paper, with door closed, place seal against door bottom and mark fixing position. Flexible seal should lightly touch the sill surface.

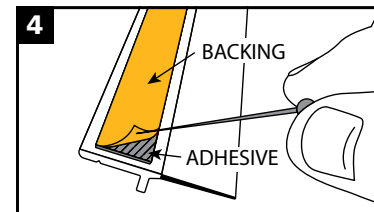

- Use a pin to carefully separate backing from adhesive.

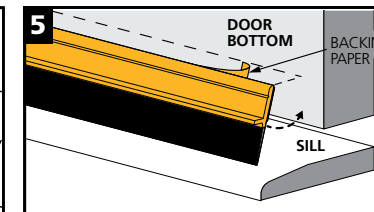

- Very carefully position seal on the marked line.
- When satisfied, firmly press seal to door surface.